

Anexo XII - Projeto Básico

Ponto	Cota (m)	Latitude (N)	Longitude (E)
1	771,0331	20°27'24,491"	45°56'36,241"
62	772,4771	20°27'24,449"	45°56'36,045"
63	773,1096	20°27'24,434"	45°56'35,990"
94	773,3555	20°27'24,373"	45°56'35,894"
95	773,2486	20°27'24,328"	45°56'35,822"
134	773,0283	20°27'24,262"	45°56'35,718"
135	773,0171	20°27'24,168"	45°56'35,626"
169	773,1072	20°27'24,059"	45°56'35,566"
170	773,1497	20°27'23,984"	45°56'35,429"
198	773,623	20°27'23,896"	45°56'35,324"
199	773,4652	20°27'23,791"	45°56'35,260"
217	773,9424	20°27'23,709"	45°56'35,251"
243	773,7157	20°27'23,519"	45°56'35,324"
242	773,2052	20°27'23,461"	45°56'35,283"
241	773,0245	20°27'23,394"	45°56'35,223"
240	774,1707	20°27'23,324"	45°56'35,160"
238	774,3537	20°27'23,296"	45°56'34,953"
237	775,8827	20°27'23,258"	45°56'34,898"
235	776,1914	20°27'23,168"	45°56'34,721"
233	777,5283	20°27'23,089"	45°56'34,521"
232	777,3586	20°27'23,019"	45°56'34,482"
231	775,4953	20°27'22,970"	45°56'34,386"
230	774,744	20°27'23,277"	45°56'34,431"
229	774,6806	20°27'23,324"	45°56'34,495"

Ponto	Cota (m)	Latitude (N)	Longitude (E)
228	774,5127	20°27'23,364"	45°56'34,548"
227	774,5489	20°27'23,409"	45°56'34,646"
226	774,4053	20°27'23,486"	45°56'34,684"
225	774,442	20°27'23,555"	45°56'34,694"
224	774,4245	20°27'23,631"	45°56'34,694"
223	774,3513	20°27'23,729"	45°56'34,730"
210	773,523	20°27'24,065"	45°56'34,638"
209	773,3581	20°27'24,299"	45°56'34,538"
185	773,0953	20°27'24,562"	45°56'34,451"
184	773,1135	20°27'24,744"	45°56'34,480"
154	774,6325	20°27'24,967"	45°56'34,524"
153	773,0523	20°27'25,198"	45°56'34,631"
114	773,76	20°27'25,282"	45°56'34,802"
113	772,7502	20°27'25,303"	45°56'34,918"
112	772,7126	20°27'25,225"	45°56'35,073"
81	772,5973	20°27'25,150"	45°56'35,321"
80	772,6038	20°27'25,119"	45°56'35,403"
49	772,5437	20°27'25,133"	45°56'35,606"
48	772,516	20°27'25,155"	45°56'35,712"
14	772,4261	20°27'25,183"	45°56'35,875"
12	772,5836	20°27'25,165"	45°56'35,964"
5	772,5854	20°27'24,994"	45°56'36,252"
4	772,6831	20°27'24,951"	45°56'36,284"
3	772,3791	20°27'24,927"	45°56'36,305"

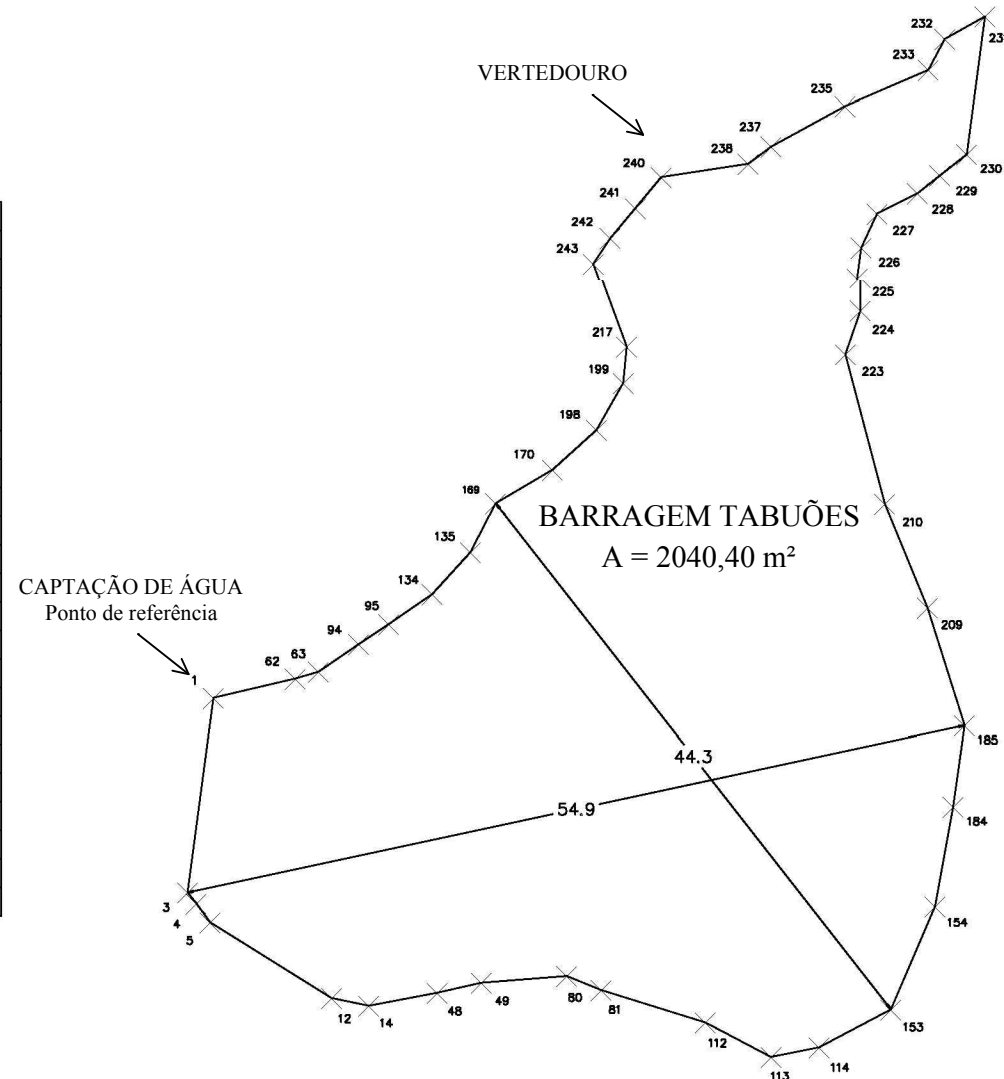

PLANTA BAIXA



SERVIÇO AUTÔNOMO DE ÁGUA E ESGOTO
Praça Zeca Soares, 2011 - Centro - Piumhi-MG
CEP 37925-000 - Telefax: (37) 3371-1332
CNPJ 23.782.816/0001-10 - Insc. Est.: Isento

Engenheiro:
JOSÉ ANTÔNIO SANSONI JÚNIOR
Engenheiro Civil
CREA MG 129.545/D

Título:
Sistema de água -
Desassoreamento
da Barragem Tabuões

Área: 2040,40 m² Volume: 3538,92 m³
Data: Julho/2018 FOLHA: 01/03
Altura média de escavação = 2,087 m